

## Adhesive Cable Holders

| Part No. | Material       | Box Qty. | Approx Box Wt. (lbs.) |
|----------|----------------|----------|-----------------------|
| 261      | Stamped Copper | 100      | 8-1/4                 |
| A261     | Aluminum       | 100      | 4                     |
| 261T     | ETPC*          | 100      | 8-1/4                 |

- Economical stamped copper adhesive cable holder.
- May be used with all cables thru 3/0 or up to 1/2" diameter.
- Fast installing cable holder designed to permit maximum movement of thermally expanding or contracting cables.

\*ETPC - Electro Tin Plated Copper

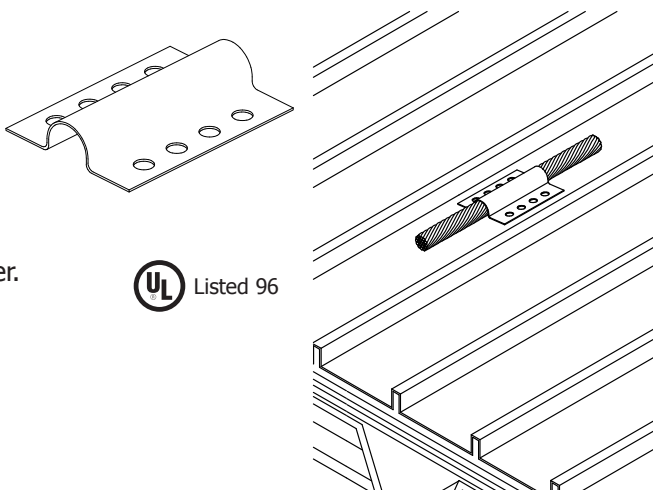

| Part No. | Material       | Box Qty. | Approx Box Wt. (lbs.) |
|----------|----------------|----------|-----------------------|
| 262      | Stamped Copper | 500      | 45                    |
| A262     | Aluminum       | 500      | 22                    |
| 262T     | ETPC*          | 500      | 45                    |

- Superior stamped copper cable holder secured by a surface compatible adhesive.
- Will not "roll-up" or loosen due to cable pull as will the round type.
- Use on any flat surface where a fast, secure, adhesive cable holder is required.
- Designed for use with all cables thru 4/0 or up to 9/16" diameter.
- Turned up edges for reduced puncture hazard and pooling area for increased adhesion.

\*ETPC - Electro Tin Plated Copper

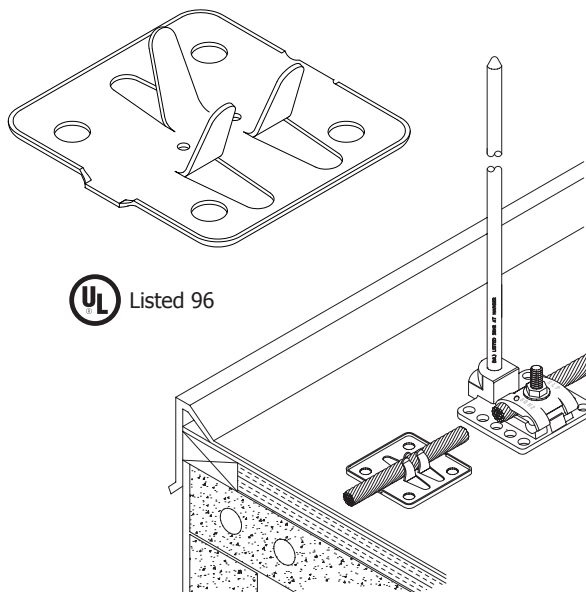

### TECHNICAL NOTES:

- Conductors shall be fastened to the structure upon which they are placed at intervals not exceeding 0.9 m (3 ft).\*
- Clips for securing copper conductors shall be cast or made from sheet copper with a minimum thickness of 0.032 inch (0.81 mm) and a minimum width of 3/8 inch (9.5 mm).\*\*
- Aluminum clips for securing aluminum conductors shall be of cast aluminum or made from sheet aluminum with a minimum thickness of 0.051 inch (1.3 mm) thick and a minimum thickness of 1/2 inch (12.7 mm) wide.\*\*

\*Per NFPA 780 Conductor Fasteners Section 4.10

\*\*UL96 Standard for Lightning Protection Components Sections 15.1 & 15.2