

REVISIONS				
REV.	DESCRIPTION	ECN	DATE	APPROVED
C	REFER TO ECN	13192	3/31/15	EJD

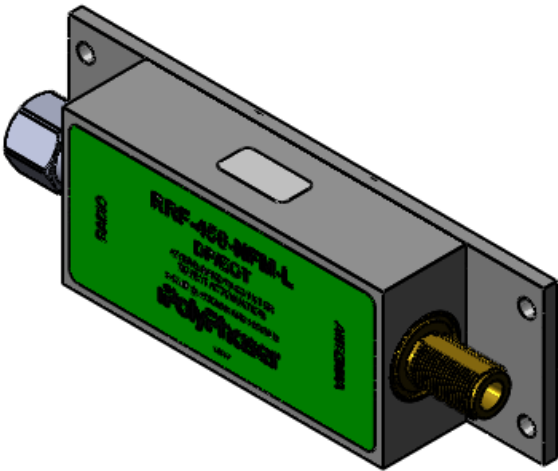
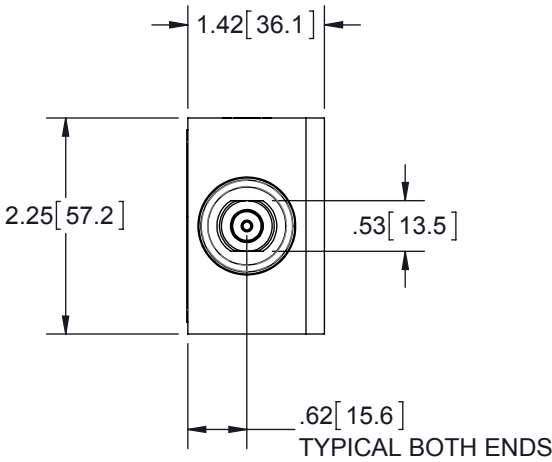
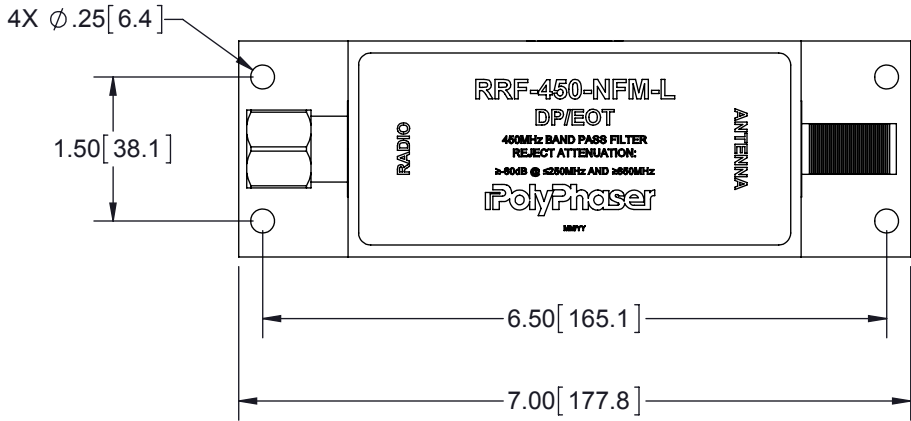
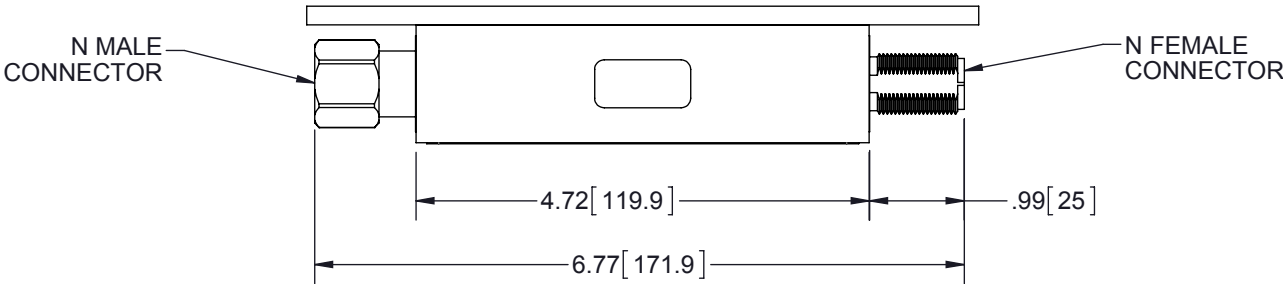

## MAXIMUM CHARACTERISTICS

**APPLICATION:**  
WEATHERIZED SURGE AND FILTER DEVICE  
FOR CO-LOCATED 160MHz, 220MHz & 450MHz  
COMMUNICATION SYSTEMS  
PANEL MOUNTING

**RF SPECIFICATIONS:**  
450MHz BAND PASS FILTER:  
450MHz - 460MHz  
RETURN LOSS: ≥20dB TYPICAL  
INSERTION LOSS: ≤1.5dB TYPICAL  
BAND REJECTION:  
INSERTION LOSS ≥ -60dB @ ≤ 250MHz  
≥ -60dB @ ≥ 650MHz TO 1GHz  
RF POWER:  
100W CONTINUOUS

**SURGE SPECIFICATIONS:**  
TURN-ON:  
90V ±20%  
MAX SURGE:  
10kA IEC 61000-4-5, 8/20 μs WAVEFORM  
THROUGHPUT ENERGY/VOLTAGE:  
<10nJ FOR 3kA, 8/20 μs WAVEFORM  
<500mVpk

**ENVIRONMENTAL:**  
MEETS IEC 60529 IP67  
MEETS BELLCORE #TA-NWT-000487  
PROCEDURE 4.11, WIND DRIVEN (120MPH)  
RAIN INTRUSION TEST.  
-40°C TO +85°C (STORAGE/OPERATING)

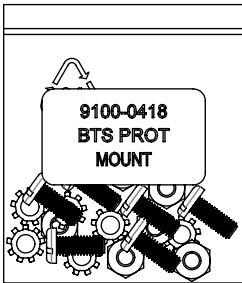

## HARDWARE KIT

4	WASHER 10 EXT TOOTH SS STAINLESS STEEL
4	NUT 10-32 HEX 18-8 SS
4	SCREW 10-32X .50 SLOT MS PAN 18-8 SS
QTY	DESCRIPTION

CUSTOMER APPROVAL: \_\_\_\_\_ DATE: \_\_\_\_\_

ALL DIMENSIONS SHOWN ARE FOR REFERENCE ONLY.

UNLESS OTHERWISE SPECIFIED LEADING DIMENSIONS ARE INCHES DIMENSIONS IN [ ] ARE MILLIMETERS		DRAWN HMB	DATE 8/22/12			
TOLERANCES: FRACTIONS=± 1/32 .XX=± .03 ANGLES=± 1 ° .XXX=± .010		ENG APPD LC	11/20/12			
MATERIAL		PRODUCT MGR SJD	11/20/12			
THIRD-ANGLE PROJECTION 		MARKETING APPD LJ	11/27/12			
NOTICE: THE INFORMATION AND DESIGN IN THIS DOCUMENT IS THE PROPERTY OF TRANSECTOR SYSTEMS. ALL RIGHTS RESERVED.		PROJECT NO.		TITLE 450MHz BAND PASS FILTER CUSTOMER SPECIFICATION		
SCALE 1:2		SIZE B	CAGE 30992	PART NUMBER RRF-450-NFM-L	REV C	
PROD CAT RFP		DOCUMENT NAME RRF-450-NFM-L-C	SHEET 1	OF 1		

THESE COMMODITIES, TECHNOLOGY OR  
SOFTWARE WERE EXPORTED FROM THE  
UNITED STATES IN ACCORDANCE WITH THE  
EXPORT ADMINISTRATION REGULATIONS.  
DIVERSION CONTRARY TO U.S. LAW PROHIBITED.