

Heavy Duty I-Beam Warehouse Mount For Enclosures

TerraWave's new Heavy Duty I-Beam Warehouse Mounting Solution for enclosures is designed to allow mounting of a 12x10x4, 12x10x6, or a 14x12x6 polycarbonate enclosure to an I-Beam. This mount can be deployed into either the vertical or horizontal plane. The low profile design with minimal components makes installation quick and easy.

In addition, the ease of installation allows the mount to be moved quickly to optimize RF coverage. Constructed of corrosion resistant 5052 aluminum this mount can be used for indoor or outdoor wi-fi deployments. This new innovative mount is also equipped to accommodate a variety of TerraWave antennas.

For questions and to purchase product, contact a Regional Sales Executive at 210-375-8482, 800-851-4965 or sales@terrawave.com.

System Highlights

- ◇ Easy installation allowing you to deploy your wireless network in an I-beam environment
- ◇ Can be moved quickly to optimize RF Coverage

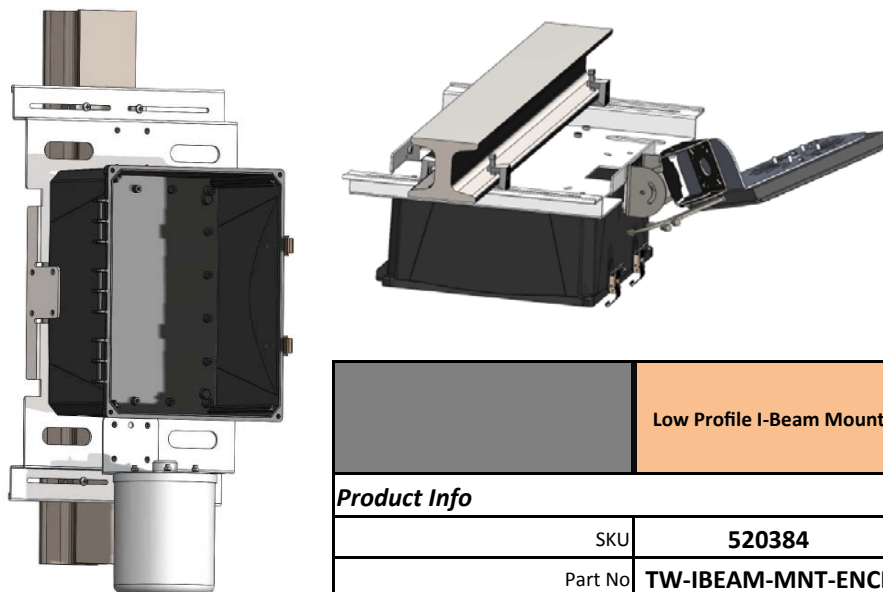

	Low Profile I-Beam Mount
Product Info	
SKU	520384
Part No	TW-IBEAM-MNT-ENCL

Features

- Can be used Indoor or Outdoor
- Constructed of Corrosion Resistant 5052 Aluminum (Marine Grade)
- Includes I-Beam Clamps
- Can accommodate I-Beams from 3"-10" in width
- Can be mounted vertically or horizontally
- 4 slots to accommodate wire/cable to secure the bracket to the I-beam should the I-Beam clamps fail
- Can accommodate any 12x10x4, 12x10x6, & 14x12x6 Polycarbonate Enclosure (Indoor or Outdoor), all panel antennas (Indoor or Outdoor), all patch antennas that can use UNIV-ART-MOUNTT (Indoor or Outdoor), and all screw mount omni antennas (Indoor Only)
- Pressed in corrosion resistant Stainless Steel Threaded Inserts for easy installation of accessories

Benefits

- Minimal components to allow for quick and easy installation
- One piece frame
- Minimal tools for installation of both accessories and the mount
- Bracket and enclosure/accessories can be assembled on the ground minimizing the amount of time a lift is required
- Only mounting one piece of equipment to I-Beam, decreasing installation costs
- No modifications need to be made to existing structure to mount bracket
- Low profile design
- Can quickly be moved to optimize RF Coverage

Heavy Duty I-Beam Warehouse Mount For Enclosures

Heavy Duty I-Beam Mount

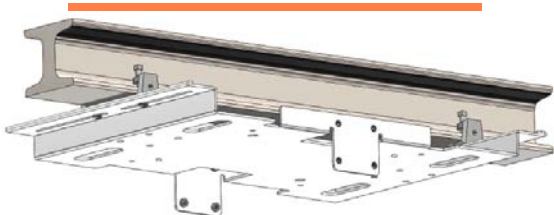

Antenna Paddle

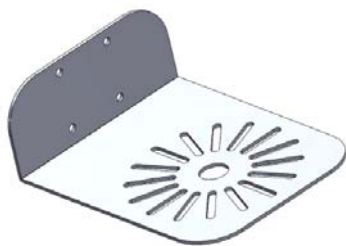

**Heavy Duty I-Beam Mount -
Vertical w/ Patch**



**Heavy Duty I-Beam Mount -
Horizontal w/ Omni**

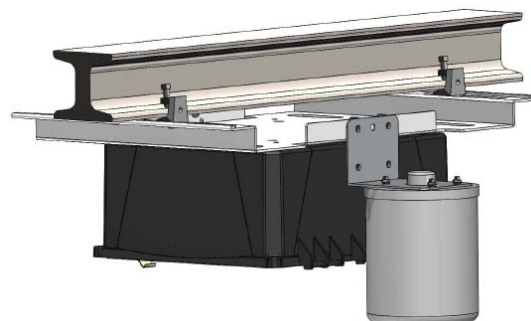

Included Accessories

- 1/4-20 X .375 SCREW - Qty 12
- I BEAM CLAMP - Qty 4
- 1/4 FLAT WASHER, 18-8 - Qty 4

Recommended /Compatible Accessories

- Antenna Paddle SKU #520049
- Any 12x10x4, 12x10x6, & 14x12x6 Polycarbonate Enclosure (Indoor or Outdoor)
- All Paint Can Antennas (Indoor or Outdoor)
- All Patch antennas that can use UNIV-ART-MOUNTT (Indoor or Outdoor) - Can be used with bracket or paddle
- All Screw Mount Omni Antennas (Indoor Only) - Antenna Paddle Required

TerraWave's enclosures have been evaluated for compliance with the Reduction of Hazardous Substances (RoHS) Directive 2002/95 and have been determined to not contain substances in excess of RoHS Maximum Concentration Levels.

In addition to enclosures for wireless deployments, TerraWave can design custom enclosures for any application including IP cameras, switches, routers and more.