



Product news
Roxtec cable entry
port seal



New Roxtec CRL cable entry port seal
Ideal cable entry seal for shelters, cabinets and conduit

The ideal cable entry port seal

Are you looking for an all-in-one cable sealing solution that is easy to install and fits any size of cable? Look no more. Regardless whether it is for a coax, signal or GPS cable, the new Roxtec CRL entry seal is unmatched in the industry. It offers flexible installation and superior protection from the environment.

Saves time and money

Our four new Roxtec CRL entry seals can replace as many as 76 different inserts that are required when using the traditional black boot. This means you can do more with much less - a 90 % reduction in inventory!

The Roxtec CRL gives you the ability to run various sizes of cable through the same opening. You no longer have to store countless inserts and hope you have the right

one to complete the job.

The Roxtec seal marks a revolution in technology for the telecom industry. It has been engineered for simplicity and reliability. Ready-made kit packages for the installer ensures always having the right product on site. With Roxtec you are able to make last minute changes in the field and add new cables over time without additional cost.



Make the professional choice and protect your equipment with the Roxtec CRL. ■

Multidiameter™ technology

One single Roxtec multidiameter module can seal cables of several different diameters simply by peeling layers away from the module

halves until it fits and seals the cable. The basic range of multidiameter modules cover diameters from 1/5" to 2 1/8" (5-54.0 mm). ■





Costly experience

The wrong choice of sealing solution costs time and money. Why sacrifice the safe and reliable protection of expensive equipment, or overlook requirements for easy maintenance, when better ways exist?



The ideal seal

Thanks to the adaptable multidiameter modules every CRL kit makes installations around existing cables easy, and the job can be finished on time, on site. A Roxtec CRL entry seal fits directly into the entry plate openings.



One instead of 76

The effectiveness of the Roxtec CRL means it can replace a variety of sizes and alternatives of products in the market. As an example the 4" Roxtec CRL replaces 76 different inserts of competing brands.



Easy to add new cables

Unused Roxtec multidiameter modules in a Roxtec CRL make it easy to add cables later on. You can combine 7/8" and 1/2" coax in the same port as LMR400. There is no need to purchase new seals for the additional cables.

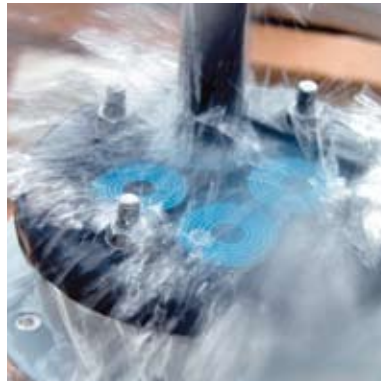

Higher level of protection

A Roxtec CRL will not allow anything to pass between the outside environment to the inside. No water, insects, dust or rodents will infiltrate the shelter or cabinet. Nothing penetrates the CRL but the cables!



Longterm reliability

The Roxtec CRL entry seal is made from resilient and sturdy materials. In contrast to traditional black boots it will sustain its sealing capacity and functionality over a long period of time. ■

Roxtec CRL kits available in 4" and 5"

For 1 cable

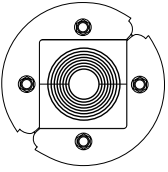

Kit		Art. No.	
Roxtec CRL 4"/1		CRL0004010012	
Roxtec CRL 5"/1		CRL0005010012	
Pcs	Module	Cable outer diameter (in)	(mm)
1	CML 66	0+0.945-2.126	0+24-54

For 4 cables

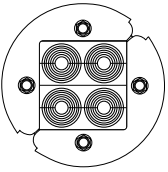

Kit		Art. No.	
Roxtec CRL 4"/4		CRL0004040012	
Roxtec CRL 5"/4		CRL0005040012	
Pcs	Module	Cable outer diameter (in)	(mm)
2	CML 33w66	2x0+0.433-1.142	2x0+11-29

For 5 cables

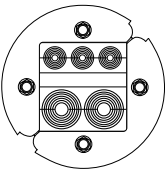

Kit		Art. No.	
Roxtec CRL 4"/5		CRL0004050012	
Roxtec CRL 5"/5		CRL0005050012	
Pcs	Module	Cable outer diameter (in)	(mm)
1	CML 22w66	3x0+0.197-0.650	3x0+5-16.5
1	CML 11/0		
1	CML 33w66	2x0+0.433-1.142	2x0+11-29

For 9 cables

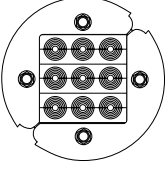

Kit		Art. No.	
Roxtec CRL 4"/9		CRL0004090012	
Roxtec CRL 5"/9		CRL0005090012	
Pcs	Module	Cable outer diameter (in)	(mm)
3	CML 22w66	3x0+0.197-0.650	3x0+5-16.5

■ All kits include Roxtec Assembly Gel and assembly instruction.

Spare modules

Kit	Module	Pcs	Art. No.
CML Kit 6601	CML 22w66	18	CMLK012266000
CML Kit 6602	CML 33w66	18	CMLK013366000
CML Kit 6603	CML 66	8	CMLK010066000
CML Kit 6604	CML 22w66	6	CMLK010066011
	CML 33w66	6	
	CML 11/0	6	

■ All spare module kits include 4 pcs of Roxtec Assembly Gel.

Roxtec CRL 4"

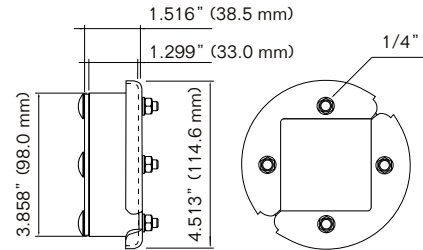

Roxtec CRL 5"

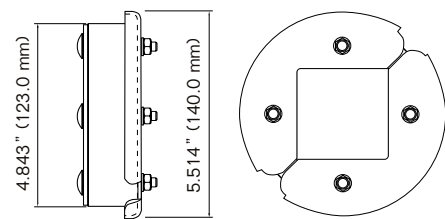

Material

Fittings: Mild steel powder coated

Frame body: Roxylon

Modules: Roxylon/SEBS

www.roxtec.com/crl



Roxtec International AB
 Box 540, 371 23 Karlskrona, SWEDEN
 PHONE +46.455.36 67 00, FAX +46.455.820 12
 EMAIL info@se.roxtec.com, www.roxtec.com